

1.50 Acre (MOL) PARCEL AVAILABLE- FOR SALE OR LEASE

NEQ of SR 52 and Little Rd | Hudson, FL 34667

Property Highlights

- ▶ 1.50-acre (MOL) parcel available
- ▶ Located at the heavily traveled and signaled intersection of Little Rd (44,000 AADT) and SR 52 (39,000 AADT)
- ▶ Co-tenancy with Wawa, Aldi, Burger King, and BB&T
- ▶ Sign panels available on monument sign along both SR 52 and Little Rd
- ▶ Local retailers include Publix Super Market, CVS, McDonald's, Dunkin', Dollar Tree, Advance Auto Parts, Family Dollar, and Taco Bell
- ▶ 0.3 miles to Fivay High School (1,750 students)
- ▶ Strong demographics include a population of over 120,000 with an average income of more than \$78,000 within a 5-mile radius

2025 DEMOGRAPHICS

Population



1 Mile	8,662
3 Mile	62,317
5 Mile	120,597

Households



1 Mile	3,954
3 Mile	27,658
5 Mile	51,978

Household Income



1 Mile	\$60,318
3 Mile	\$74,884
5 Mile	\$78,478

Traffic Counts



Little Rd	44,000 AADT
State Rd 52	39,000 AADT

Daytime Demos



Businesses	Employees	Daytime Population
1 Mile 388	1 Mile 1,817	1 Mile 5,996
3 Mile 2,360	3 Mile 12,031	3 Mile 41,498
5 Mile 5,153	5 Mile 30,118	5 Mile 82,586

1.50 Acre (MOL) PARCEL AVAILABLE FOR SALE OR LEASE

NEQ of SR 52 and Little Rd | Hudson, FL 34667

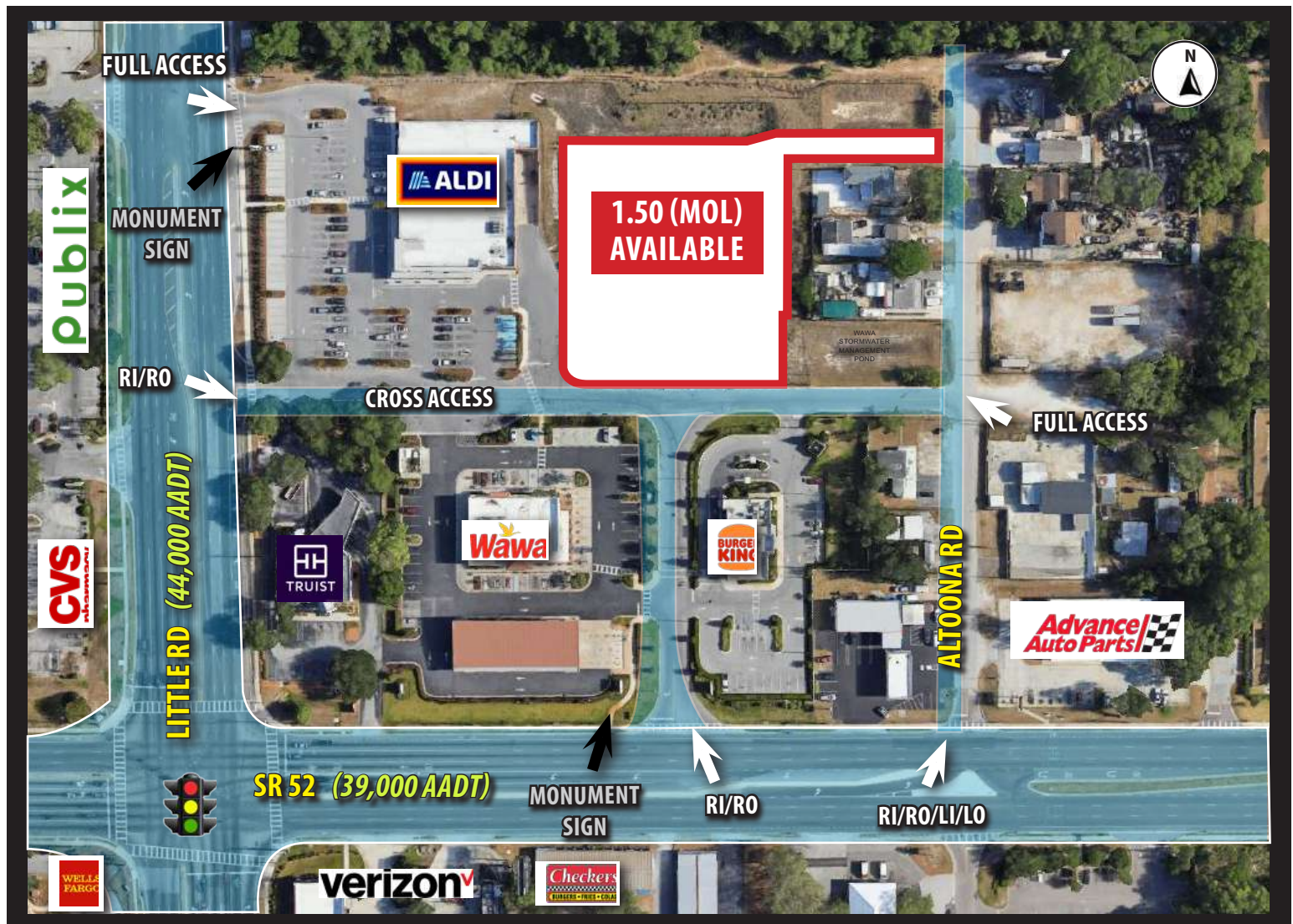

Brandon Eggleston
813 712 3068
brandon@rmcpg.com

8902 N Dale Mabry Hwy
Tampa, FL 33614
800 728 5379
www.RMCPG.com

1.50 Acre (MOL) PARCEL AVAILABLE FOR SALE OR LEASE

NEQ of SR 52 and Little Rd | Hudson, FL 34667



Little Rd Sign



SR 52 Sign



All information given herein is obtained from sources considered reliable. However, we are not responsible for misstatement of facts, errors, omissions, prior sale, withdrawal from market, modification of mortgage commitment, terms and considerations, or change in price without notice. The information supplied herein is for informational purposes only and shall not contain a warranty or assurance that said information is correct. Any person intending to rely upon the information supplied herein should verify said information independently. **UPDATED:042326**

Brandon Eggleston
813 712 3068
brandon@rmcpg.com

8902 N Dale Mabry Hwy
Tampa, FL 33614
800 728 5379
www.RMCPG.com