

GULF POINTS SQUARE

15551 – 15660 San Carlos Blvd | Ft Myers, FL 33908



PROPERTY HIGHLIGHTS

- 1.33-1.76 acre outparcels available along San Carlos Blvd & McGregor Blvd
- Retail pad along San Carlos Blvd (14,500 AADT) has 220 feet of frontage and retail pad along McGregor Blvd (17,500 AADT) has 185' feet of frontage
- 350 new multi family units going directly behind retail outparcels
- Surrounding area retailers: Publix, CVS, Walgreens, Target, Chase, Wells Fargo, Truist, Fifth Third, Bank of America, Dollar Tree, O'Reilly, Wendy's & Dunkin
- Population of 114,480 within a 5-mile radius of subject site
- Demographics include an average income of more than \$116,000 within a 5-mile radius

KEY DEMOS	1 MILE	3 MILES	5 MILES
POPULATION			
2025 Estimated Population	9,045	48,033	114,480
2025 Estimated Households	4,851	24,580	58,045
INCOME			
2025 Estimated Avg HH Income	\$113,257	\$117,819	\$116,618
AGE			
Median Age	59	60	58
DAYTIME DEMOS			
Number of Businesses	731	2,674	8,435
Number of Employees	4,171	14,213	43,192
Total Daytime Population	8,801	41,084	101,962
TRAFFIC COUNTS			
McGregor Blvd (E/W)	17,500 AADT		
San Carlos Blvd (N/S)	14,500 AADT		

Brandon Eggleston
 813 712 3068
 brandon@rmcpg.com

8902 N Dale Mabry Hwy
 Tampa, FL 33614
 800 728 5379
 www.RMCPG.com

GULF POINTS SQUARE

15551 – 15660 San Carlos Blvd | Ft Myers, FL 33908

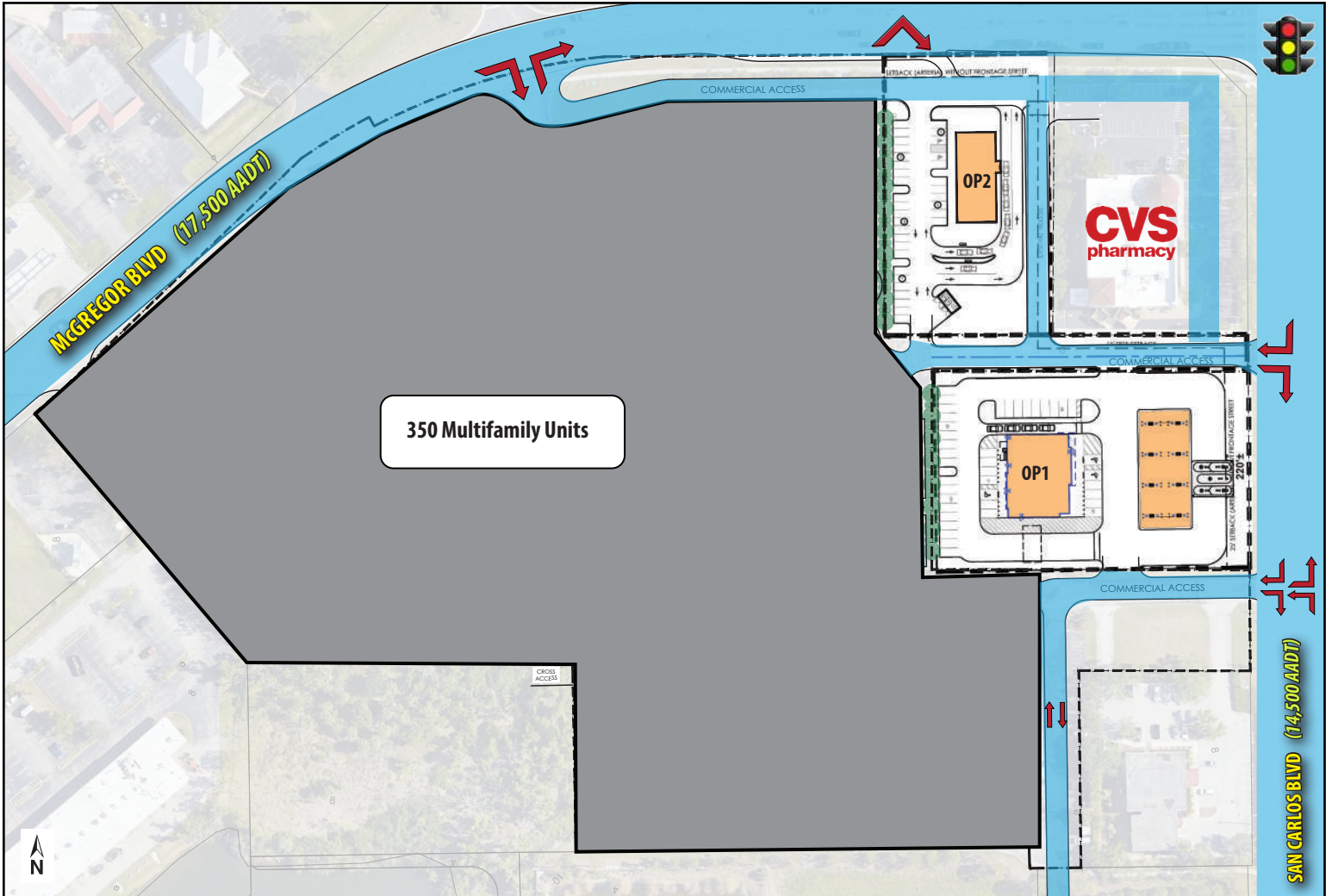

All information given herein is obtained from sources considered reliable. However; we are not responsible for misstatement of facts, errors, omissions, prior sale, withdrawal from market, modification of mortgage commitment, terms and considerations, or change in price without notice. The information supplied herein is for informational purposes only and shall not contain a warranty or assurance that said information is correct. Any person intending to rely upon the information supplied herein should verify said information independently. **UPDATED:042426**

Brandon Eggleston
813 712 3068
brandon@rmcpg.com

8902 N Dale Mabry Hwy
Tampa, FL 33614
800 728 5379
www.RMCPG.com